

Situaties en details

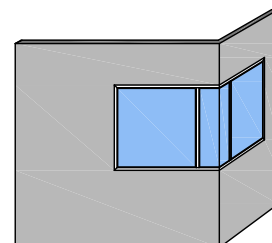

Tekening: IS-IS-situaties-20130819
 Formaat: A4
 Schaal: 1:1
 Datum: 04-08-2013
 - Auteursrechten volgens de wet voorbehouden
 - Maten in het werk te controleren

BIA Systeemwanden B.V.
 Postbus 99, 6600 AB, Wijchen
 Almereweg 25, 1671 ND, Medemblik
 T: 0227 570 622
 F: 0227 542 782
 W: www.bia-systeemwanden.nl

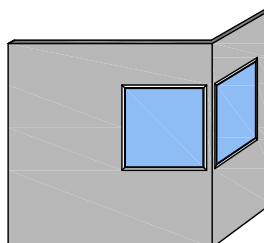
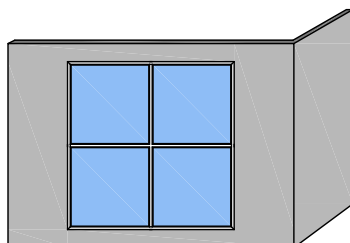
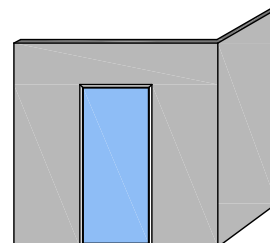
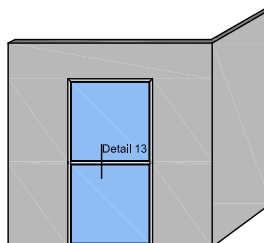
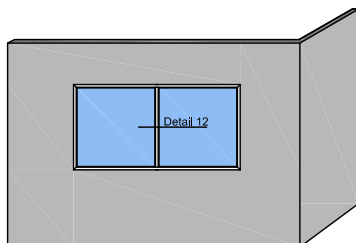
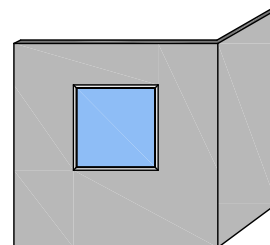
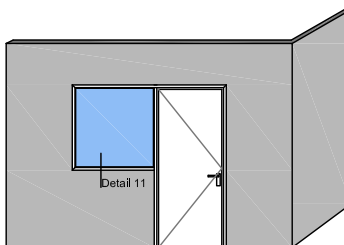
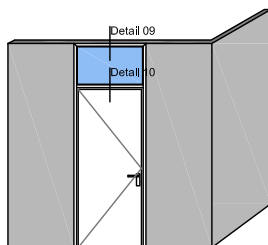
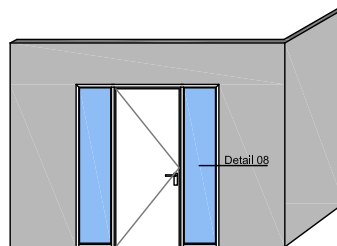
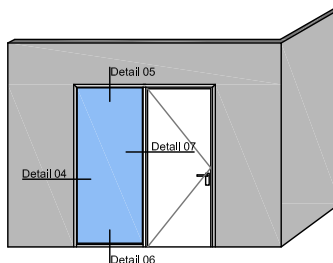
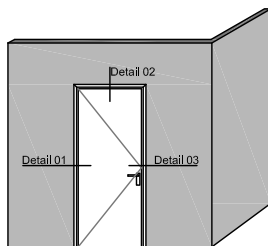

Maatvoering

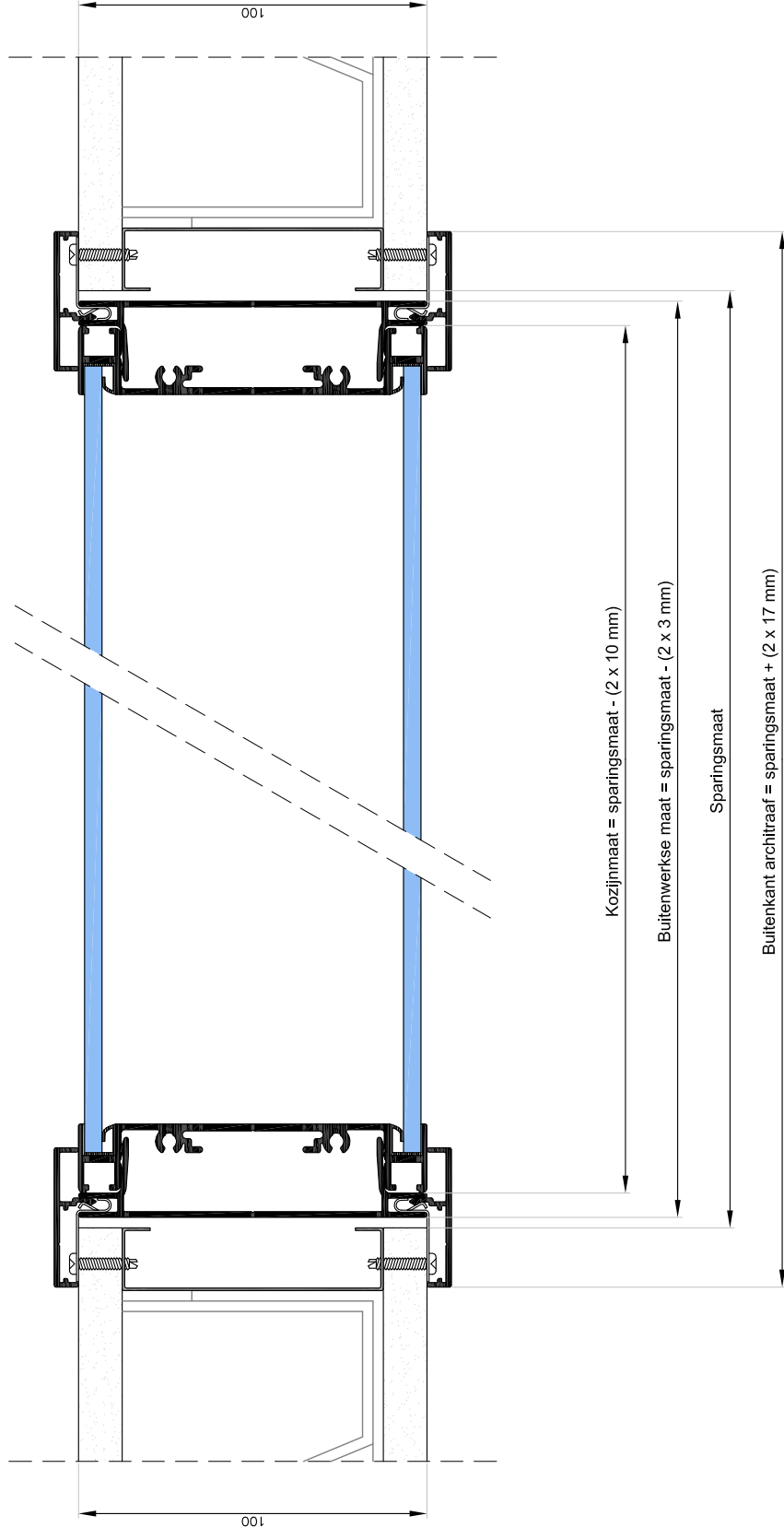

Tekening: IS-IS-maatvoering-20130819

Formaat: A4

Schaal: 1:1

Datum: 04-08-2013

- Auteursrechten volgens de wet voorbehouden
- Maten in het werk te controleren

MURUS
NASTEL DEUR- & RAAMKOZIJNEN

BIA Systeemwanden B.V.

Postbus 99, 6600 AB, Wijchen

Almereweg 25, 1671 ND, Medemblik

T: 0227 570 622

F: 0227 542 782

W: www.bia-systeemwanden.nl



Plaatsing van bevestigingsclips

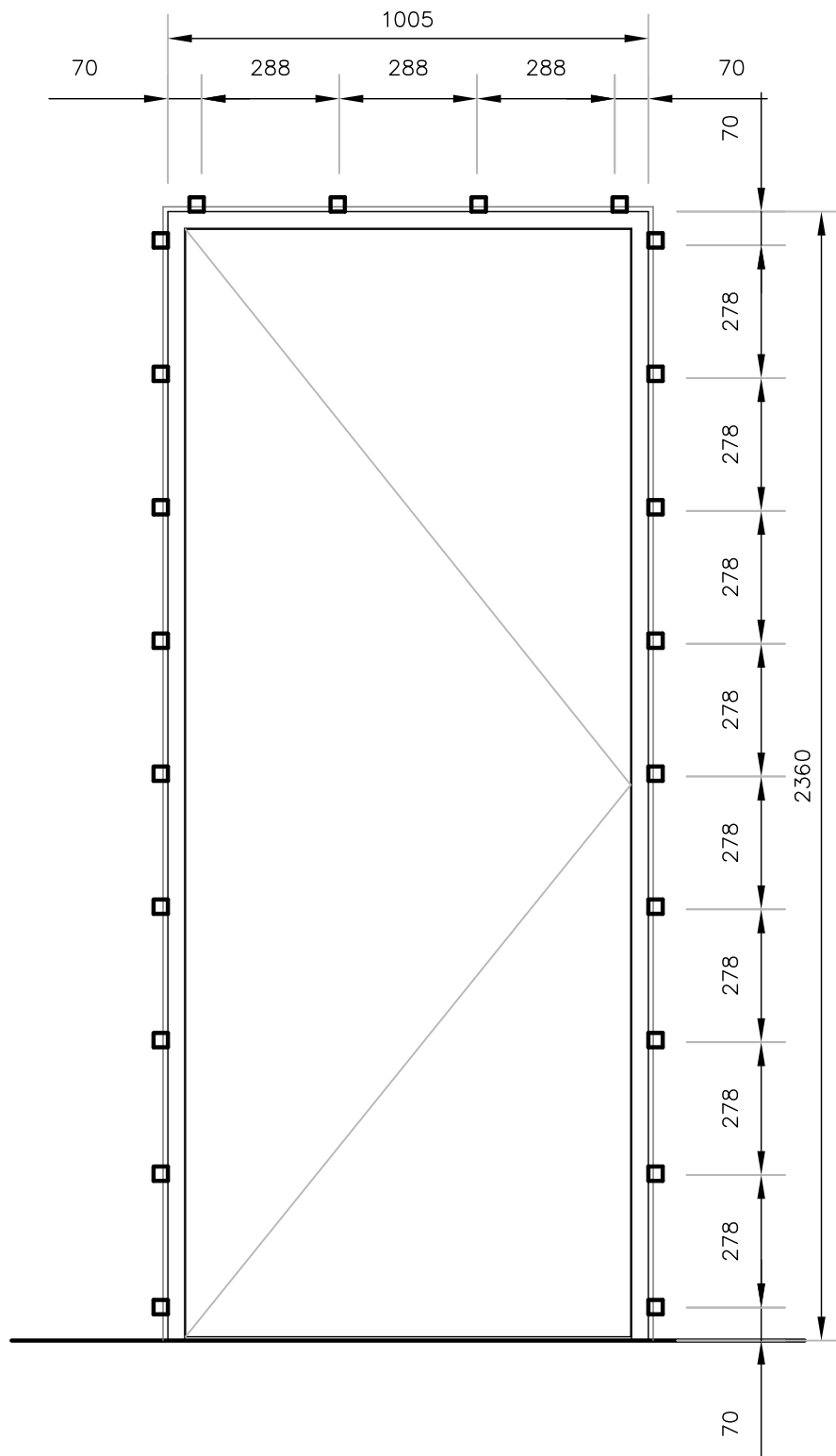

Door middel van de montageclips worden de vensters en deurkozijnen bevestigd met de MS-wand. De eerste clip dient op maximaal 70 mm uit de hoek geplaatst te worden. De afstand tussen twee opeenvolgende clips mag maximaal 300mm zijn.



Tekening: IS-IS-clips-20130819

Formaat: A4

Schaal: 1:1

Datum: 04-08-2013

- Auteursrechten volgens de wet voorbehouden
- Maten in het werk te controleren

BIA Systeemwanden B.V.

Postbus 99, 6600 AB, Wijchen

Almereweg 25, 1671 ND, Medemblik

T: 0227 570 622

F: 0227 542 782

W: www.bla-systeemwanden.nl



Detail 1

Horizontaal

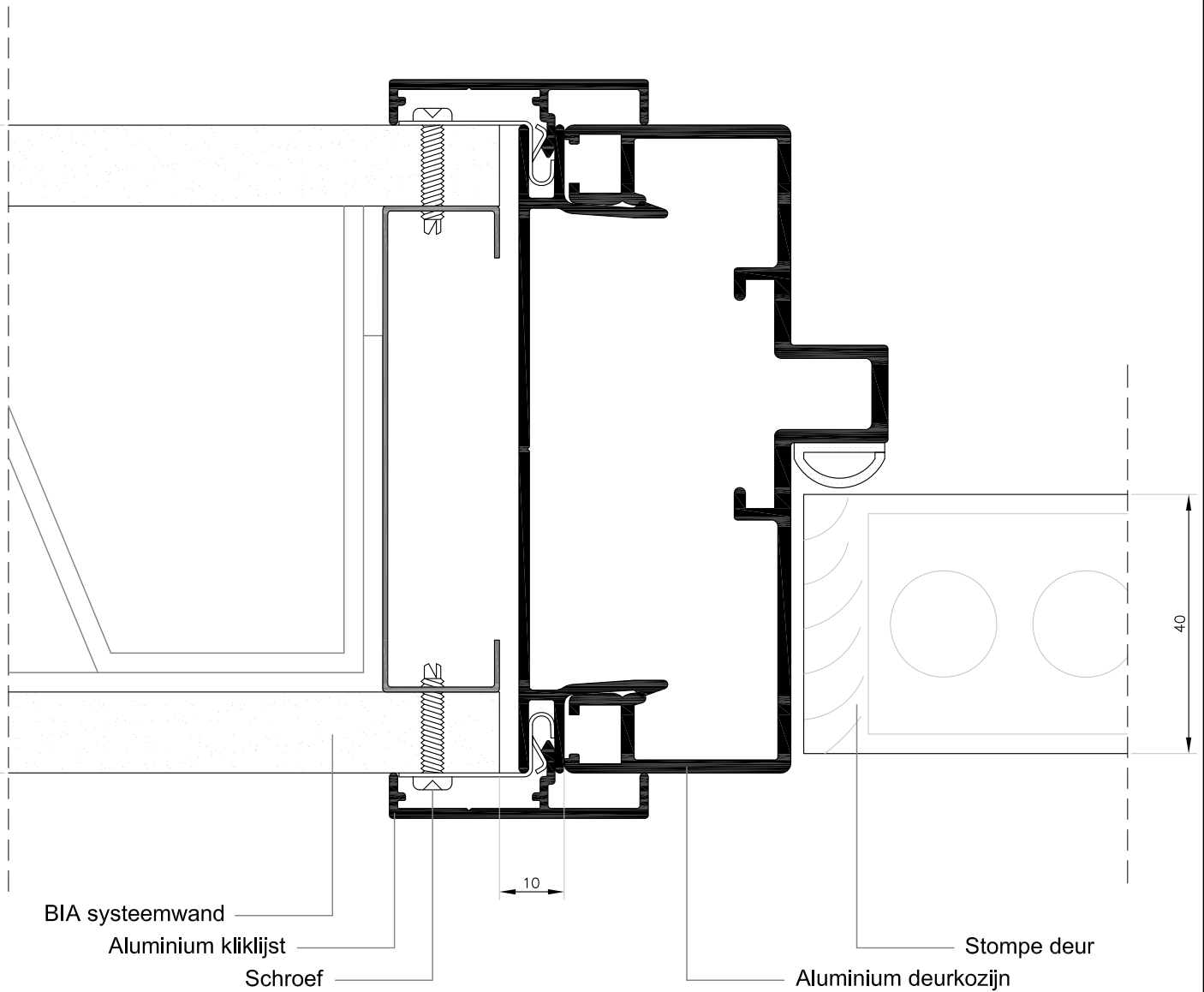

Detail 2

Verticaal

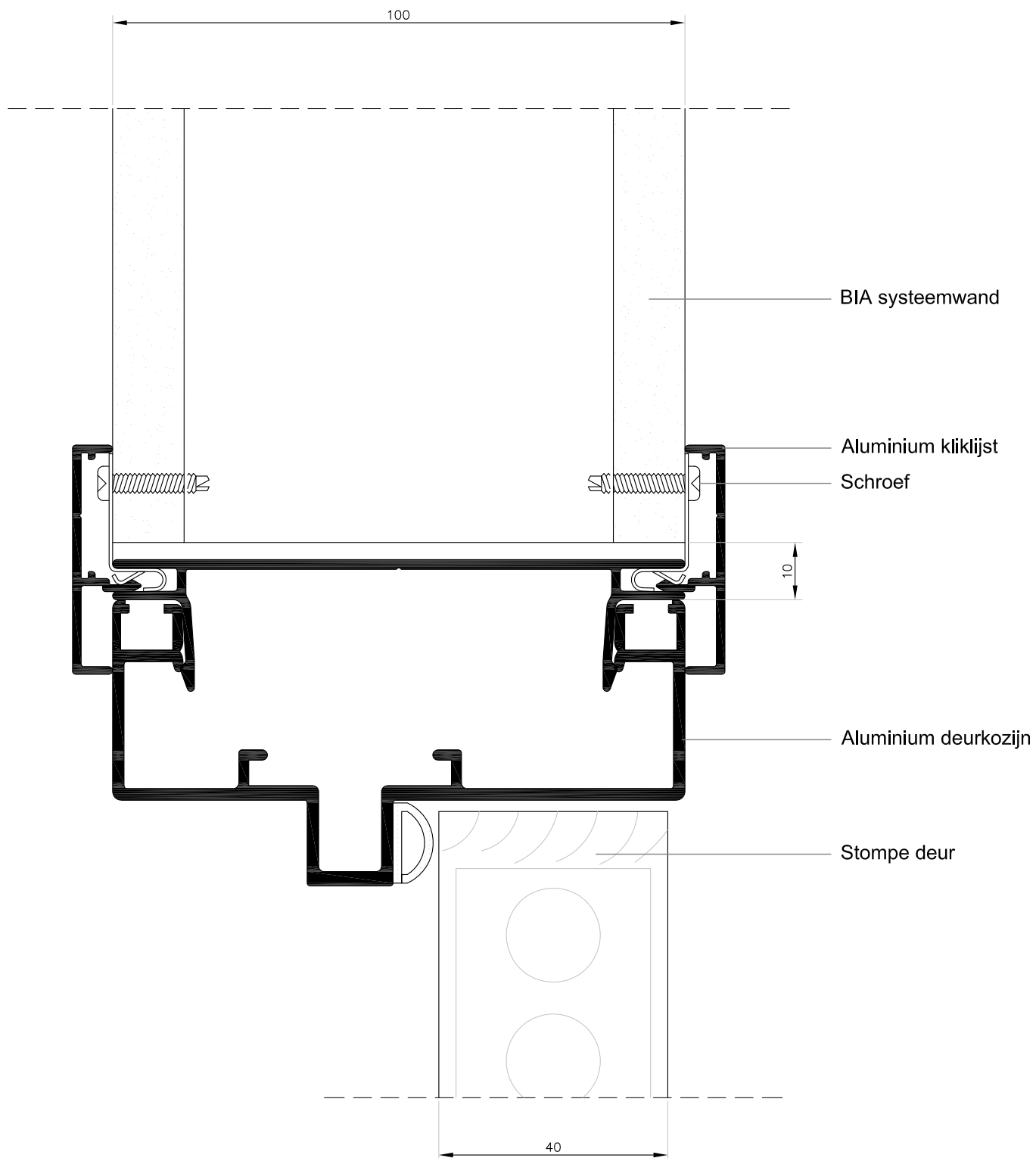

Detail 3

Horizontaal

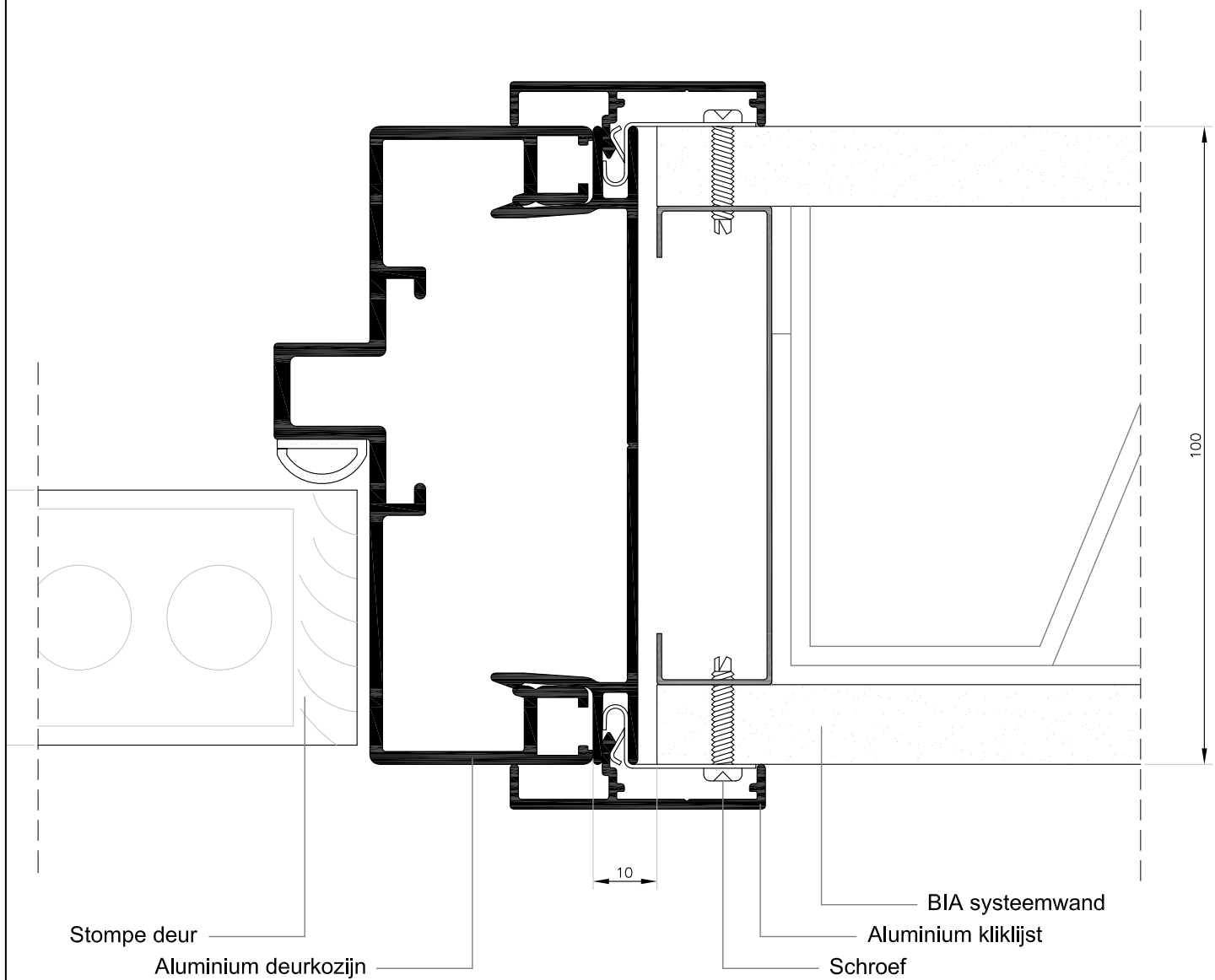

Detail 4

Horizontaal

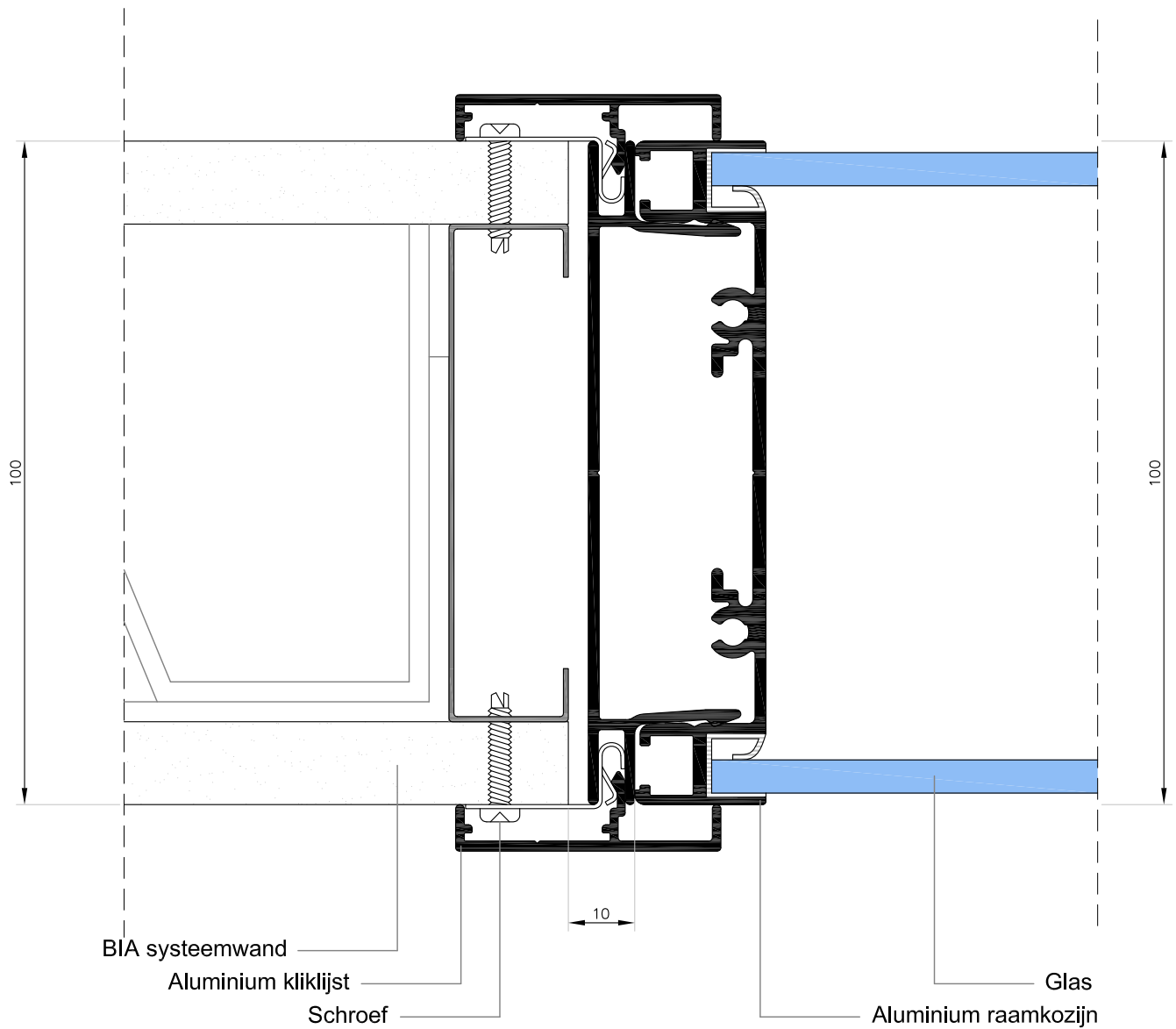

Detail 5

Verticaal

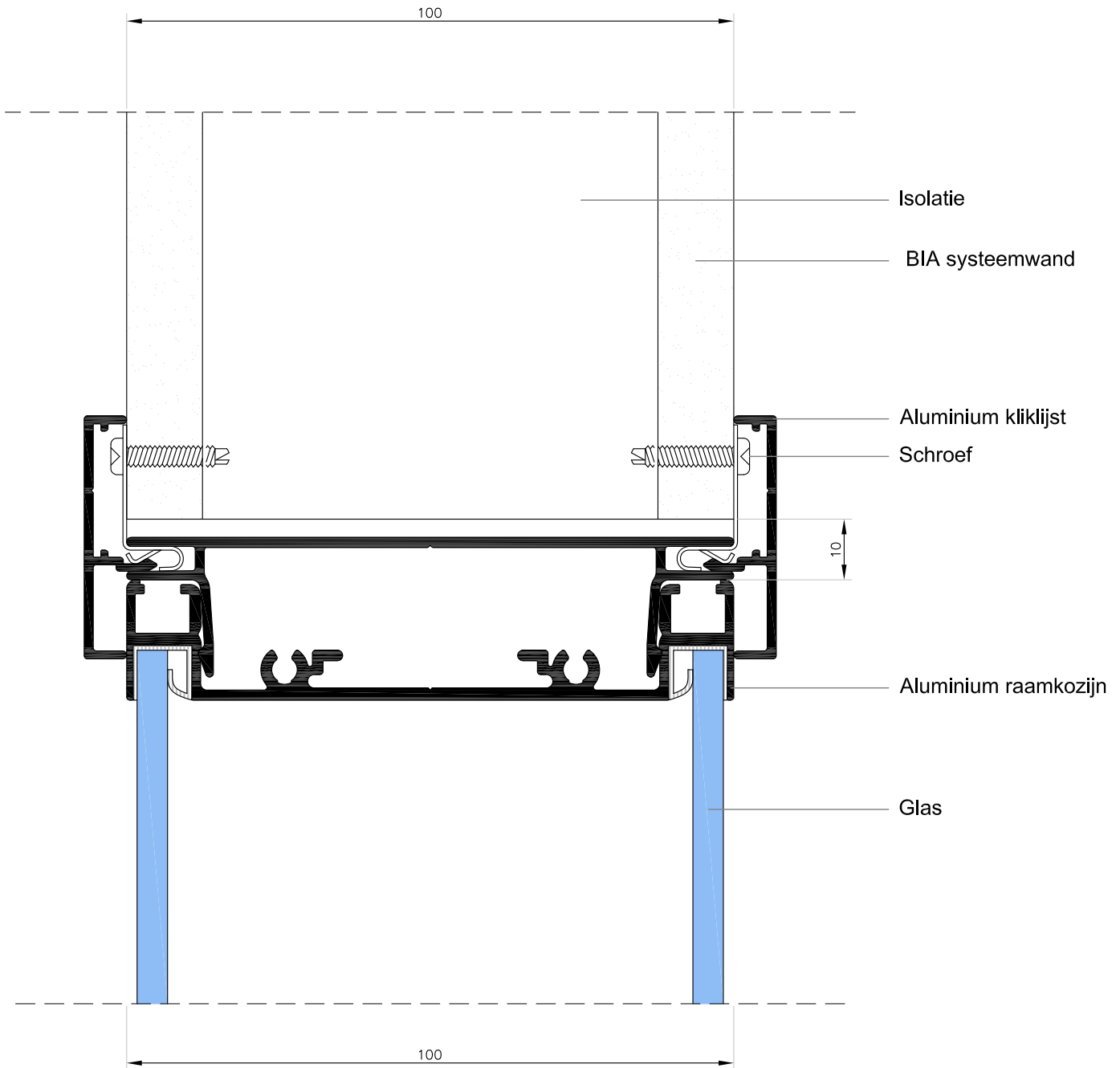

Detail 6

Verticaal

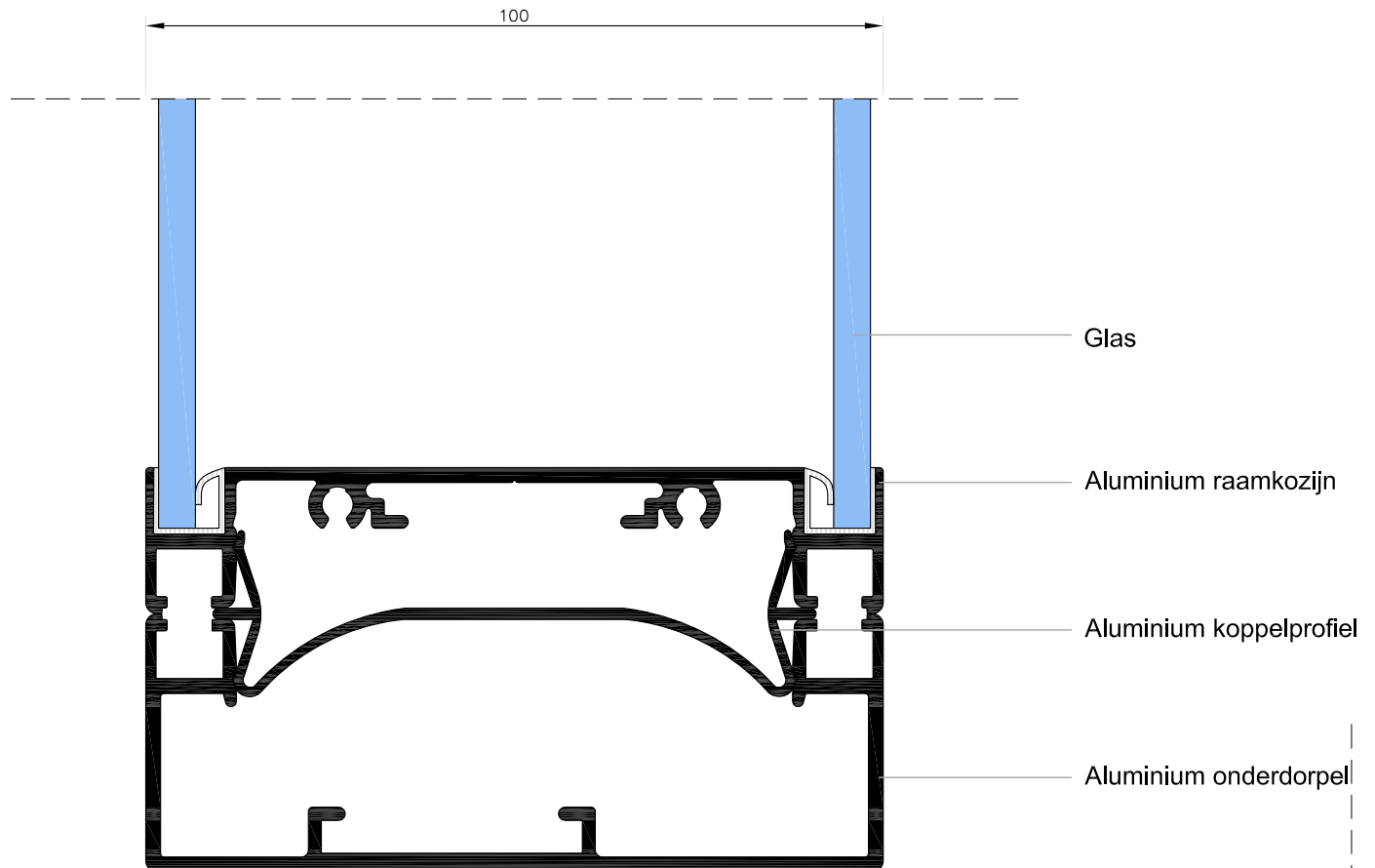

Detail 7

Horizontaal

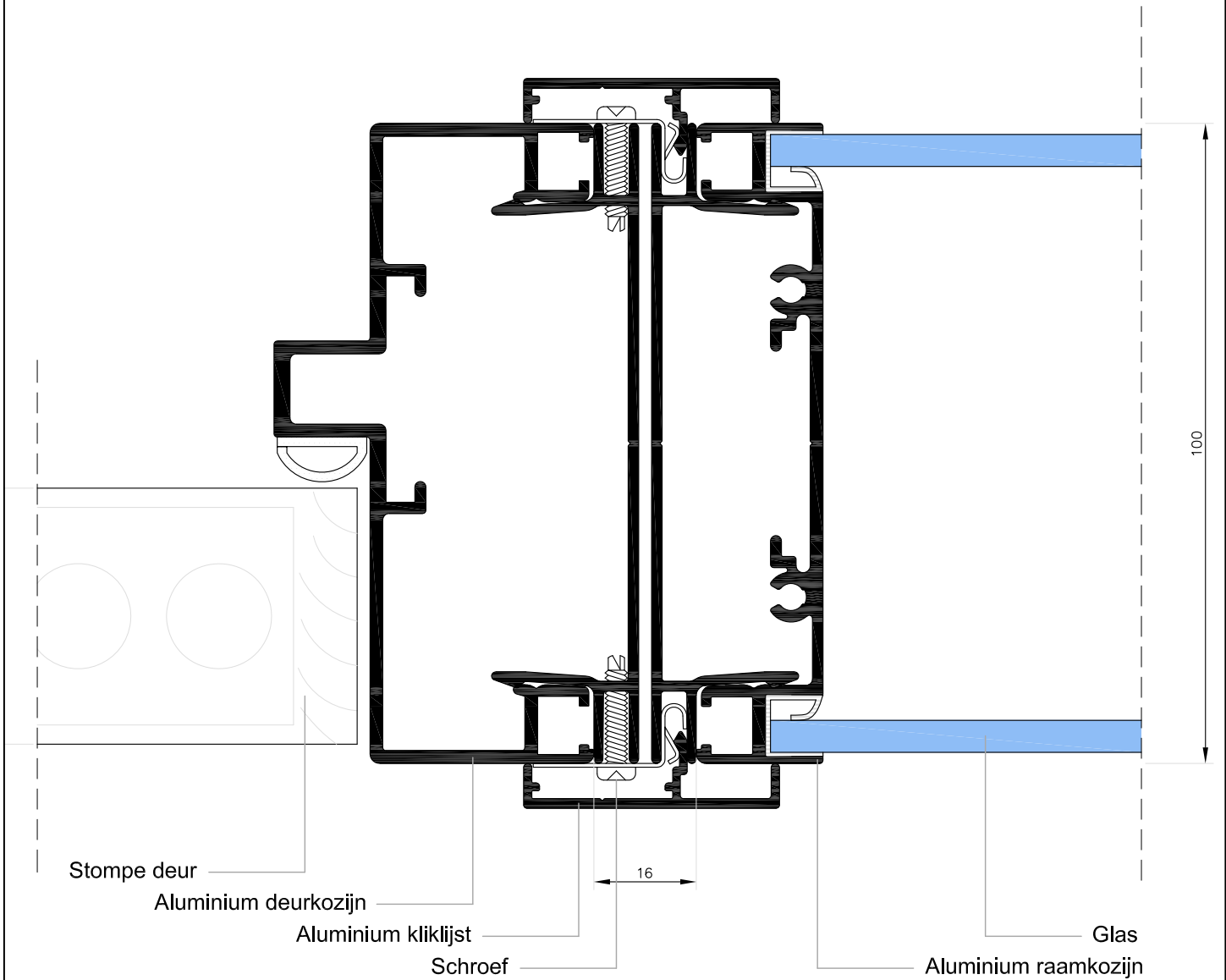

Detail 8

Horizontaal

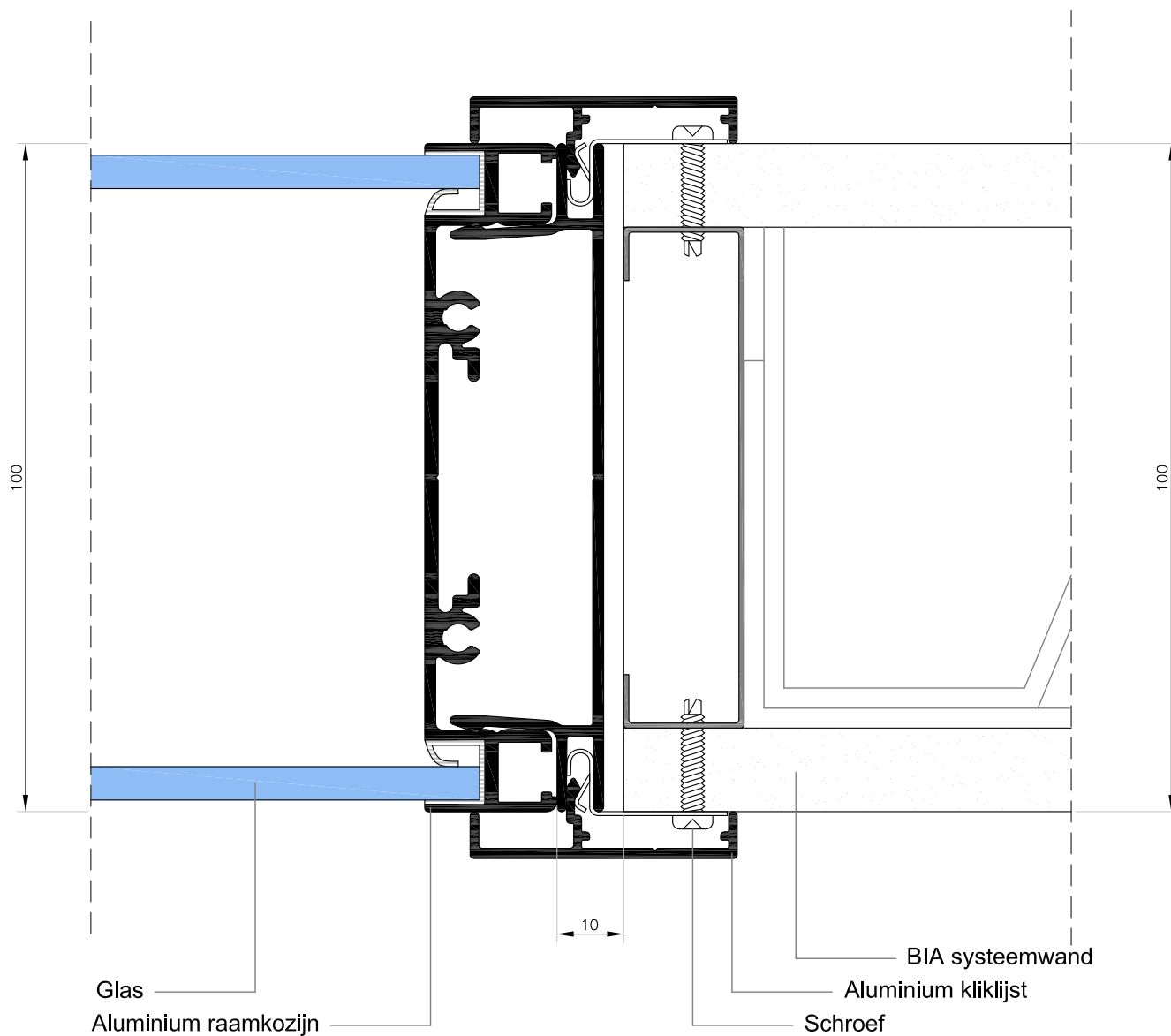

Detail 9

Verticaal

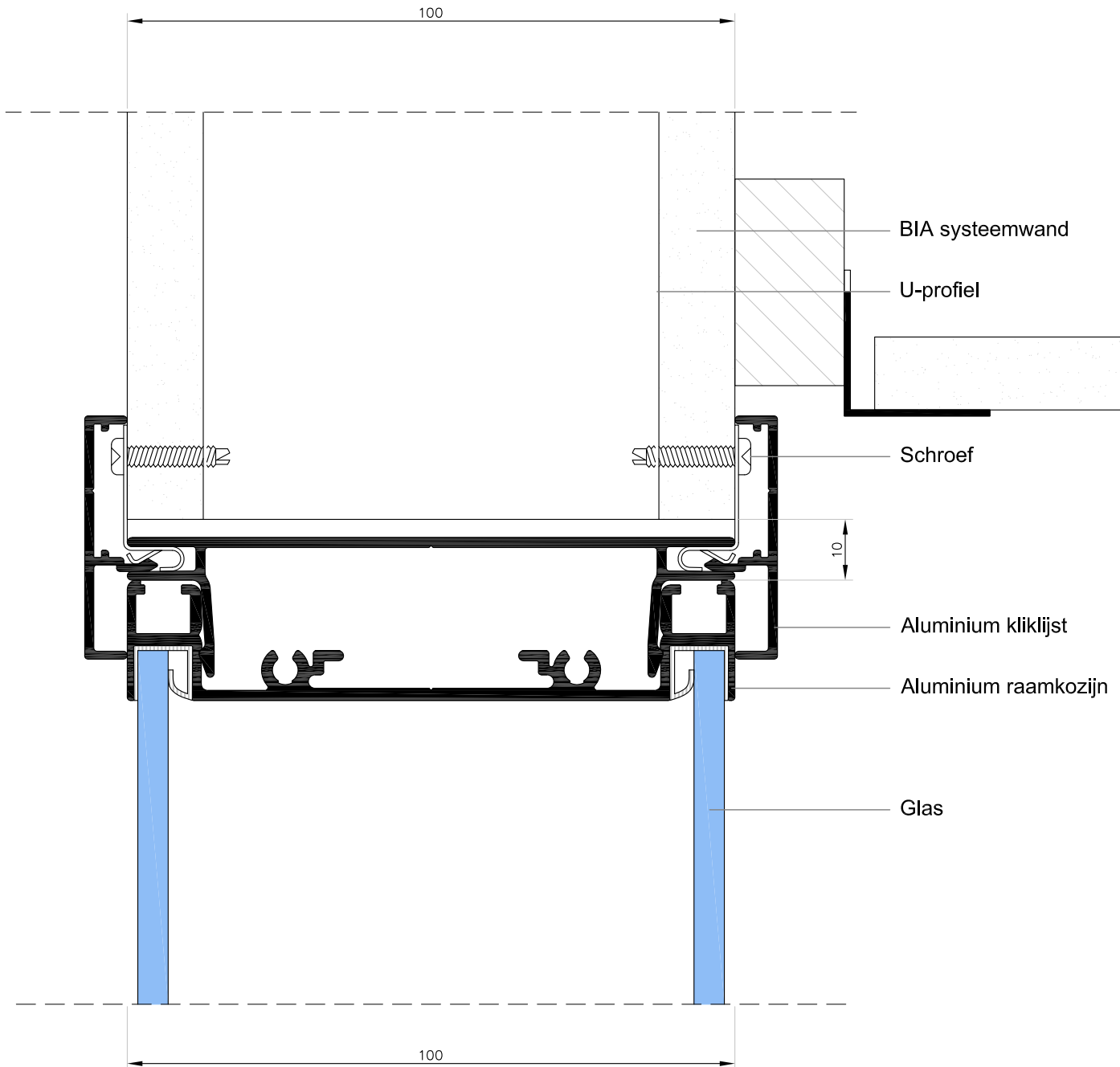

Detail 10

Verticaal

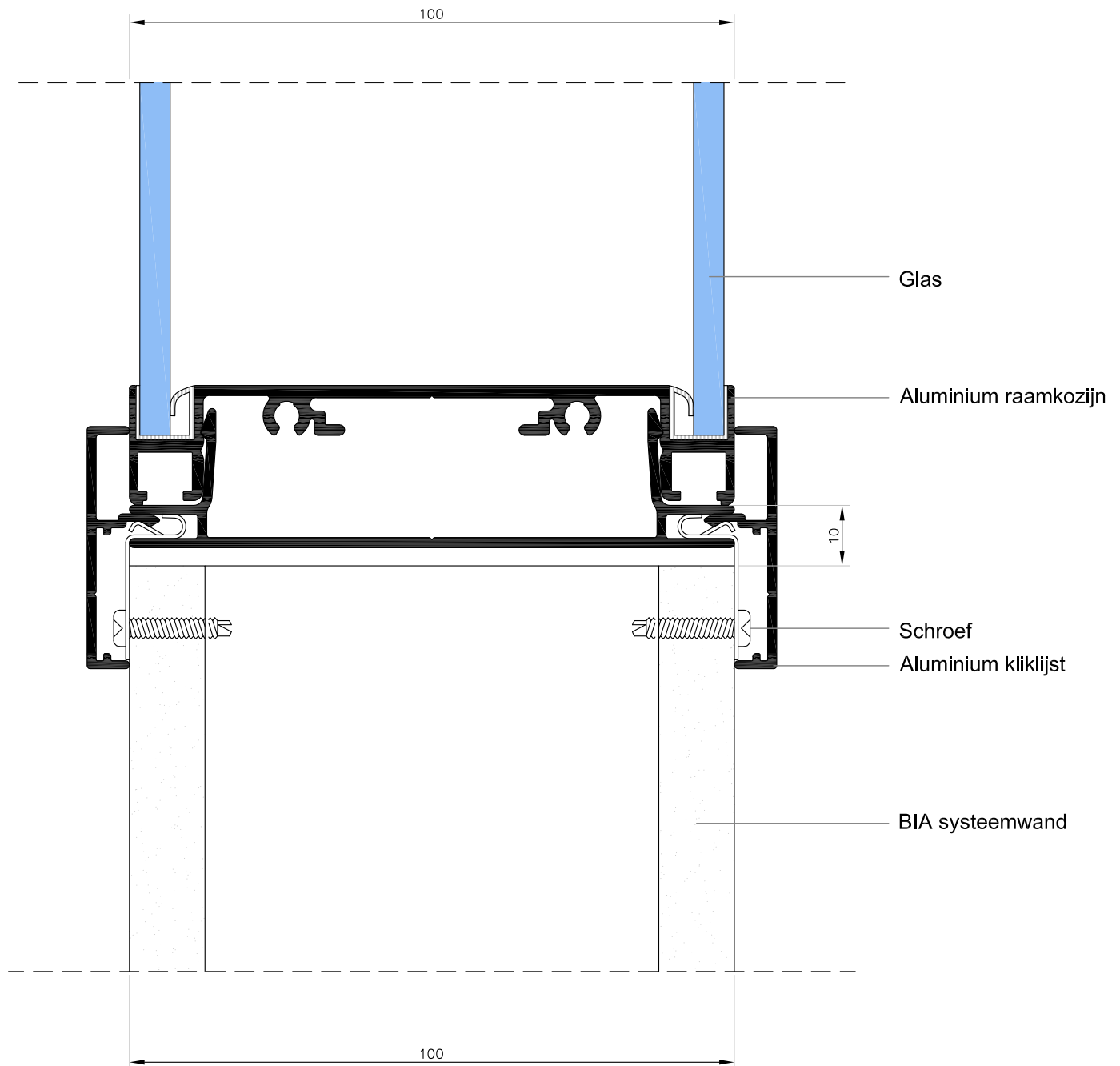

Detail 11

Verticaal

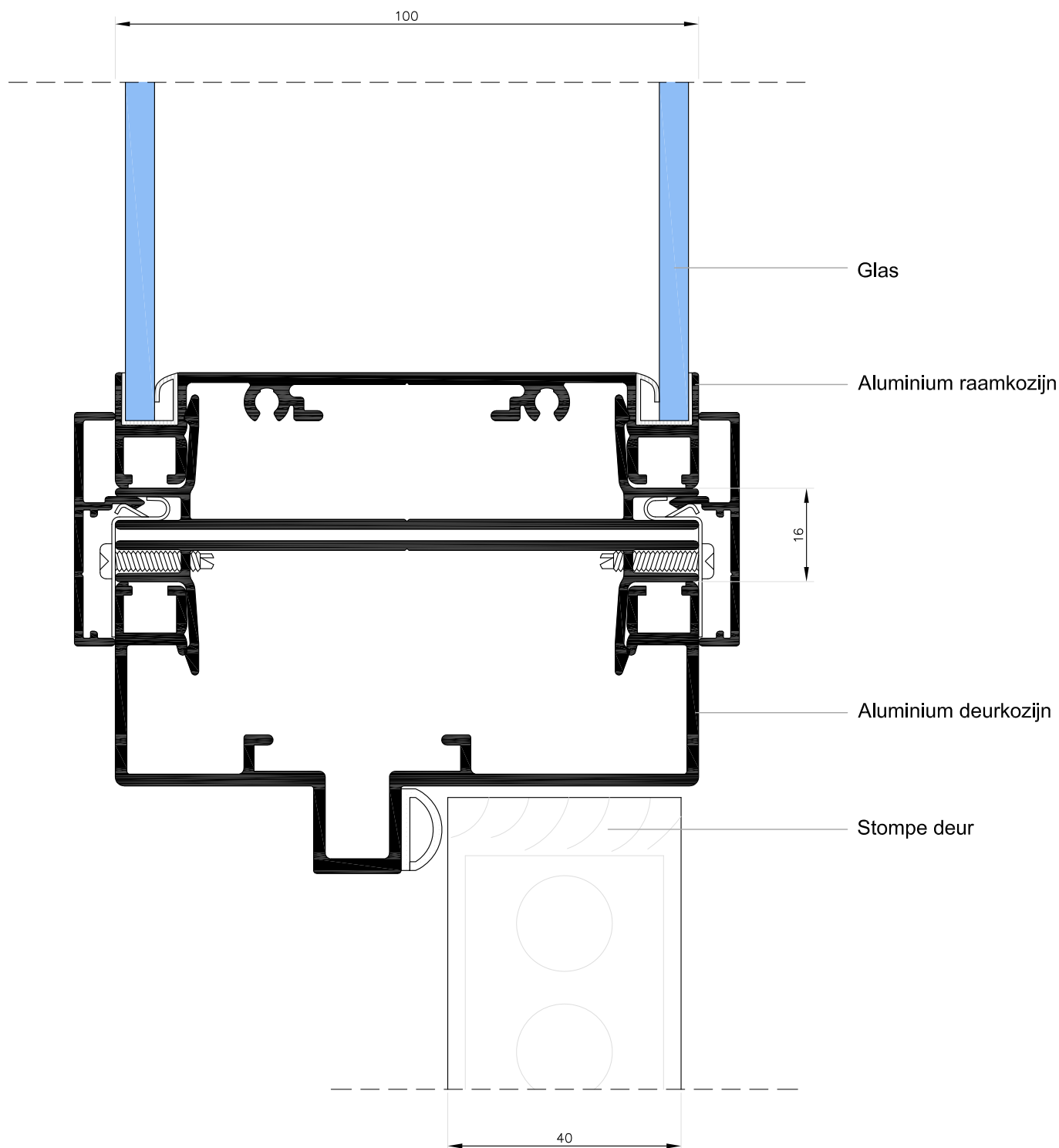

Detail 12

Horizontaal

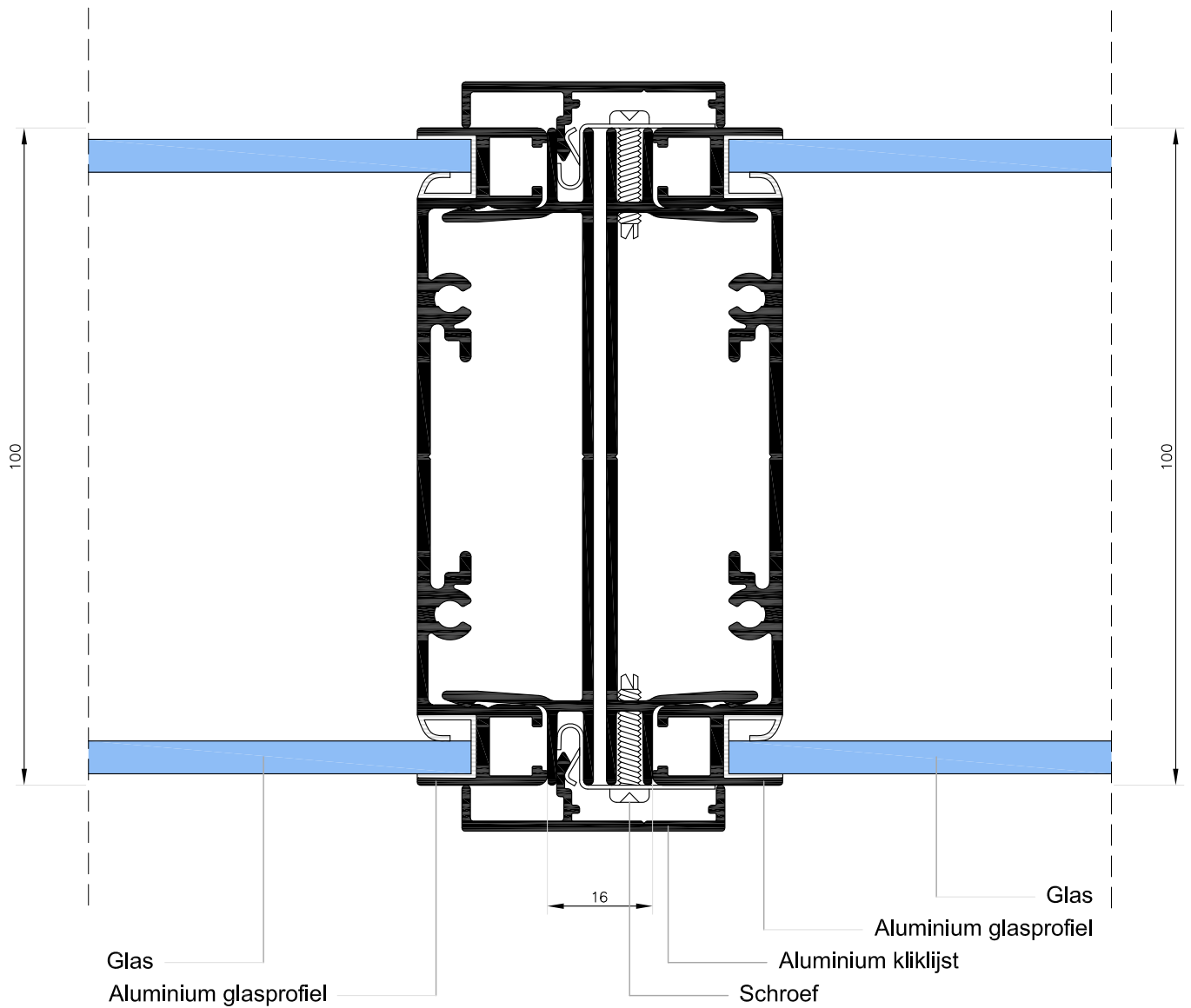

Detail 13

Verticaal

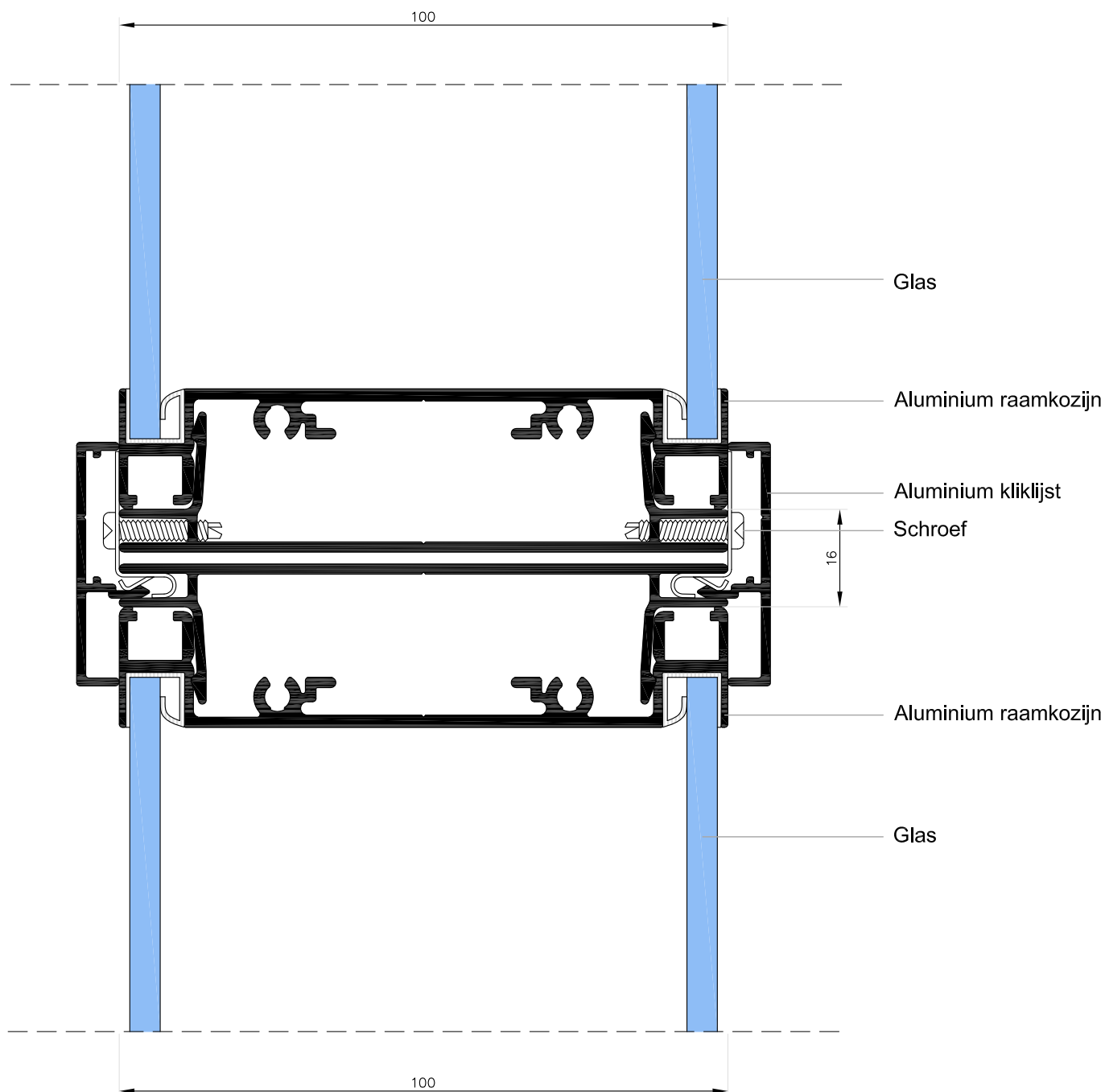

Detail 14

Verticaal

